

# دیتاشیت و مشخصات فنی گیربکس بول هلیکال شریف

## اجزاء سازنده

### Components

| No.   | Name              |
|-------|-------------------|
| [1]   | Pinion            |
| [2]   | Gear              |
| [3]   | Pinion shaft      |
| [4]   | Gear              |
| [5]   | Pinion shaft      |
| [6]   | Gear              |
| [7]   | Output shaft      |
| [8]   | Key               |
| [9]   | Oil seal          |
| [11]  | Rolling bearing   |
| [12]  | Retaining ring    |
| [17]  | Spacer tube       |
| [19]  | Key               |
| [20]  | Breather valve    |
| [22]  | Gear unit housing |
| [25]  | Rolling bearing   |
| [30]  | Rolling bearing   |
| [31]  | Key               |
| [37]  | Rolling bearing   |
| [39]  | Retaining ring    |
| [42]  | Rolling bearing   |
| [43]  | Key               |
| [45]  | Rolling bearing   |
| [59]  | Screw plug        |
| [83]  | Shield ring       |
| [84]  | Shield ring       |
| [88]  | Retaining ring    |
| [89]  | Closing cap       |
| [100] | Inspection cover  |
| [101] | Hex head screw    |
| [102] | Gasket            |
| [113] | Slotted nut       |
| [114] | Multi-tang washer |
| [116] | Thread lock       |

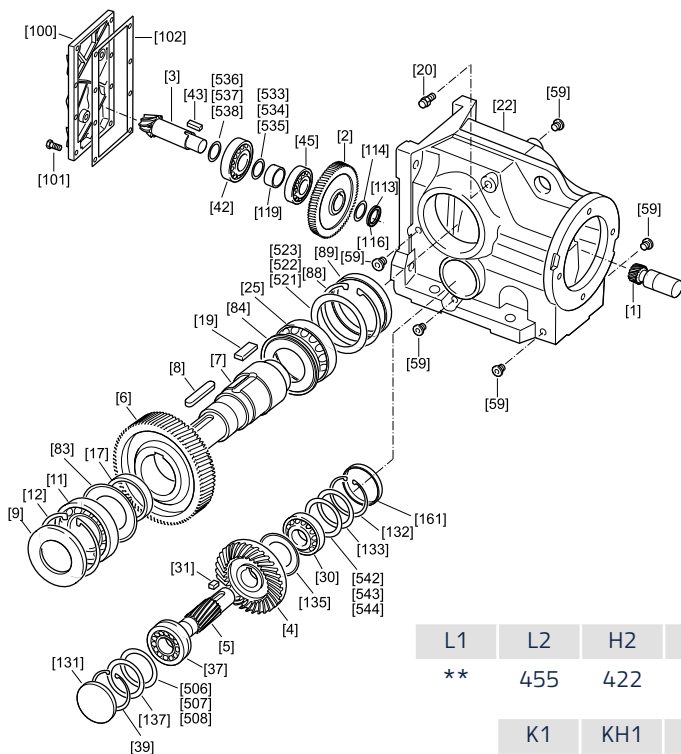

| No.         | Name            |
|-------------|-----------------|
| [119]       | Spacer tube     |
| [131]       | Closing cap     |
| [132]       | Retaining ring  |
| [133]       | Supporting ring |
| [135]       | Shield ring     |
| [137]       | Supporting ring |
| [506]-[544] | Shim            |

## نقشه انفجاری

### Exploded view drawing

## K97

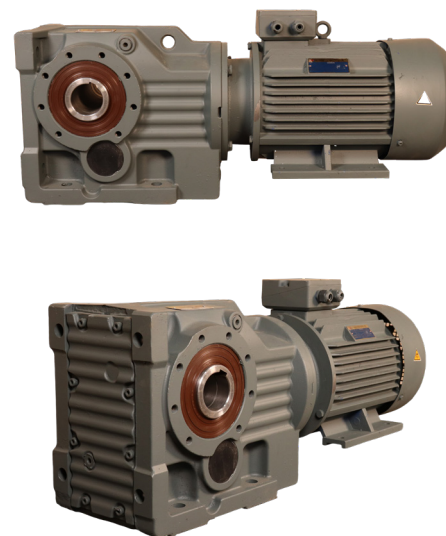

## مشخصات عمومی

### General information

|         |   |
|---------|---|
| فولاد   | جنس دنده  |
| Steel   | Gear material   |
| چدن     | جنس پوسته   |
| Iron    | Shell material  |
| 70 (mm) | قطر شافت یا هالو شافت خروجی<br>Output shaft or hollow shaft diameter                              |
| 75 (mm) | قطر هالو شافت در صورت استفاده از شیرینگ دیسک<br>The diameter of the hollow shaft with shrink disk |

## ابعاد و اندازه

### Dimensions and size

| L1 | L2   | H2  | Ch  | CL  | W   | Wb  | Hb  | OL  | Lb  | Od  | K   | Kh   | OD | EH  |
|----|------|-----|-----|-----|-----|-----|-----|-----|-----|-----|-----|------|----|-----|
| ** | 455  | 422 | 265 | 160 | 290 | 240 | 295 | 140 | 240 | 70  | 20  | 62.5 | 70 | 300 |
| K1 | KH1  | OD2 | EH2 | Hb  | D   | b1  | b2  | b3  | TH  | d2  | d3  | b    |    |     |
| 20 | 74.9 | 75  | 340 | 295 | 210 | 65  | 92  | 100 | 352 | 350 | 450 | 41.5 |    |     |



KA series

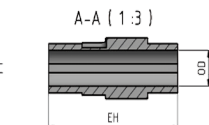

KH series

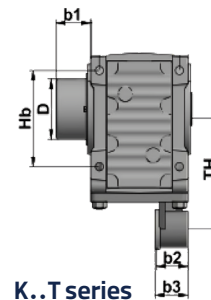

K..T series

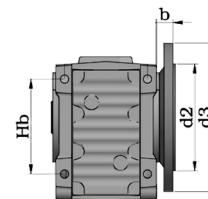

KF series

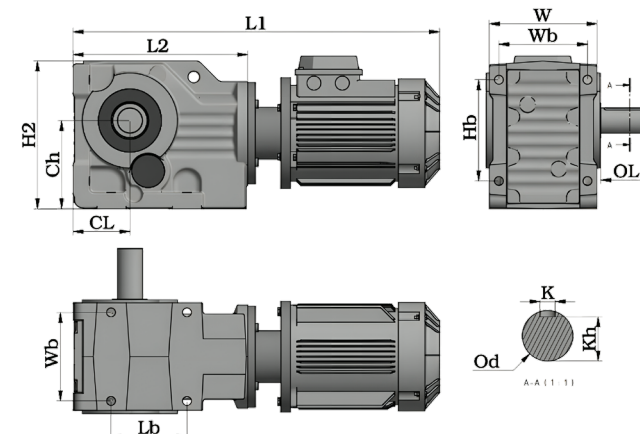

| Power |      | Speed | Pole | n2    | Ratio  | T     | Fs   |
|-------|------|-------|------|-------|--------|-------|------|
| (kw)  | (hp) | (rpm) | Num  | (rpm) |        | (N.m) |      |
| 1.5   | 2    | 1000  | 6P   | 5     | 187.72 | 2101  | 1.43 |
| 1.5   | 2    | 1000  | 6P   | 8     | 115.71 | 1791  | 2.4  |
| 1.5   | 2    | 1000  | 6P   | 10    | 99.47  | 1433  | 2.5  |
| 1.5   | 2    | 1500  | 4P   | 10    | 139.54 | 1433  | 3.1  |
| 2.2   | 3    | 1500  | 4P   | 10    | 139.54 | 2101  | 2    |
| 2.2   | 3    | 1500  | 4P   | 13    | 107.61 | 1616  | 2.45 |
| 2.2   | 3    | 1000  | 6P   | 7     | 139.54 | 3001  | 1.35 |
| 2.2   | 3    | 1000  | 6P   | 11    | 85.76  | 1910  | 1.68 |
| 2.2   | 3    | 1000  | 6P   | 15    | 64.19  | 1401  | 2.83 |
| 3     | 4    | 1000  | 6P   | 9     | 99.47  | 3183  | 1.26 |
| 3     | 4    | 1000  | 6P   | 15    | 64.19  | 1910  | 2.12 |
| 3     | 4    | 1000  | 6P   | 20    | 47.28  | 1433  | 3.11 |
| 3     | 4    | 1500  | 4P   | 7     | 203.08 | 4093  | 1    |
| 3     | 4    | 1500  | 4P   | 10    | 139.54 | 2865  | 1.56 |
| 3     | 4    | 1500  | 4P   | 13    | 115.71 | 2204  | 1.84 |
| 3     | 4    | 1500  | 4P   | 17    | 82.48  | 1685  | 1.84 |
| 3     | 4    | 1500  | 4P   | 20    | 71.12  | 1433  | 1.84 |
| 3     | 4    | 1500  | 4P   | 24    | 61.31  | 1194  | 3.3  |
| 4     | 5.5  | 1000  | 6P   | 15    | 64.19  | 2547  | 1.54 |
| 4     | 5.5  | 1000  | 6P   | 20    | 47.28  | 1910  | 2.26 |
| 4     | 5.5  | 1500  | 4P   | 16    | 89.29  | 2388  | 1.3  |
| 4     | 5.5  | 1500  | 4P   | 20    | 71.12  | 1910  | 1.34 |
| 4     | 5.5  | 1500  | 4P   | 24    | 61.31  | 1592  | 2.44 |
| 4     | 5.5  | 1500  | 4P   | 30    | 47.28  | 1273  | 3.44 |
| 5.5   | 7.5  | 1000  | 6P   | 15    | 61.31  | 3502  | 1.18 |

| Power |      | Speed | Pole | n2    | Ratio | T     | Fs   |
|-------|------|-------|------|-------|-------|-------|------|
| (kw)  | (hp) | (rpm) | Num  | (rpm) |       | (N.m) |      |
| 5.5   | 7.5  | 1000  | 6P   | 20    | 47.28 | 2626  | 1.66 |
| 5.5   | 7.5  | 1500  | 4P   | 24    | 61.31 | 2189  | 1.79 |
| 5.5   | 7.5  | 1500  | 4P   | 30    | 47.28 | 1751  | 2.5  |
| 5.5   | 7.5  | 1500  | 4P   | 38    | 37.68 | 1382  | 2.72 |
| 7.5   | 10   | 1500  | 4P   | 24    | 61.31 | 2984  | 1.34 |
| 7.5   | 10   | 1500  | 4P   | 30    | 47.28 | 2388  | 1.89 |
| 7.5   | 10   | 1500  | 4P   | 38    | 37.68 | 1885  | 2    |
| 7.5   | 10   | 1500  | 4P   | 42    | 34.12 | 1705  | 2.32 |
| 7.5   | 10   | 1500  | 4P   | 51    | 28.2  | 1404  | 2.77 |
| 7.5   | 10   | 1000  | 6P   | 20    | 47.28 | 3581  | 1.25 |
| 7.5   | 10   | 1000  | 6P   | 34    | 28.2  | 2107  | 1.83 |
| 7.5   | 10   | 1000  | 6P   | 44    | 21.75 | 1628  | 2.58 |
| 7.5   | 10   | 1000  | 6P   | 55    | 17.33 | 1302  | 3.2  |
| 11    | 15   | 1500  | 4P   | 30    | 47.28 | 3502  | 1.26 |
| 11    | 15   | 1500  | 4P   | 38    | 37.68 | 2764  | 1.36 |
| 11    | 15   | 1500  | 4P   | 42    | 34.12 | 2501  | 1.55 |
| 11    | 15   | 1500  | 4P   | 51    | 28.2  | 2060  | 1.85 |
| 11    | 15   | 1500  | 4P   | 66    | 21.57 | 1592  | 2.6  |
| 11    | 15   | 1500  | 4P   | 72    | 20.11 | 1459  | 2.87 |
| 11    | 15   | 1000  | 6P   | 28    | 34.12 | 3752  | 1    |
| 11    | 15   | 1000  | 6P   | 33    | 28.7  | 3183  | 1.2  |
| 11    | 15   | 1000  | 6P   | 44    | 21.75 | 2388  | 1.72 |
| 11    | 15   | 1000  | 6P   | 55    | 17.33 | 1910  | 2.19 |
| 15    | 20   | 1000  | 6P   | 44    | 21.75 | 3256  | 1.29 |
| 15    | 20   | 1000  | 6P   | 55    | 17.33 | 2605  | 1.64 |

| Power |      | Speed | Pole | n2    | Ratio | T     | Fs   |
|-------|------|-------|------|-------|-------|-------|------|
| (kw)  | (hp) | (rpm) | Num  | (rpm) |       | (N.m) |      |
| 15    | 20   | 1500  | 4P   | 33    | 43.71 | 4341  | 1    |
| 15    | 20   | 1500  | 4P   | 51    | 28.2  | 2809  | 1.38 |
| 15    | 20   | 1500  | 4P   | 66    | 21.75 | 2170  | 1.95 |
| 15    | 20   | 1500  | 4P   | 72    | 20.11 | 1990  | 2.15 |
| 15    | 20   | 1500  | 4P   | 84    | 17.33 | 1705  | 2.52 |
| 15    | 20   | 1500  | 4P   | 96    | 14.99 | 1492  | 2.49 |
| 18.5  | 25   | 1000  | 6P   | 44    | 21.75 | 4015  | 1    |
| 18.5  | 25   | 1000  | 6P   | 55    | 17.33 | 3212  | 1.3  |
| 18.5  | 25   | 1500  | 4P   | 66    | 21.75 | 2677  | 1.56 |
| 18.5  | 25   | 1500  | 4P   | 72    | 20.11 | 2454  | 1.72 |
| 18.5  | 25   | 1500  | 4P   | 84    | 17.33 | 2103  | 2    |
| 18.5  | 25   | 1500  | 4P   | 96    | 14.99 | 1840  | 1.99 |
| 18.5  | 25   | 1500  | 4P   | 115   | 12.61 | 1536  | 2.33 |
| 18.5  | 25   | 1500  | 4P   | 125   | 11.56 | 1413  | 2.8  |
| 22    | 30   | 1500  | 4P   | 55    | 17.33 | 3820  | 1.1  |
| 22    | 30   | 1500  | 4P   | 66    | 21.75 | 3183  | 1.3  |
| 22    | 30   | 1500  | 4P   | 72    | 20.11 | 2918  | 1.43 |
| 22    | 30   | 1500  | 4P   | 84    | 17.33 | 2501  | 1.68 |
| 22    | 30   | 1500  | 4P   | 96    | 14.99 | 2189  | 1.66 |
| 22    | 30   | 1500  | 4P   | 115   | 12.61 | 1827  | 1.95 |
| 22    | 30   | 1500  | 4P   | 125   | 11.56 | 1681  | 2.33 |
| 30    | 40   | 1500  | 4P   | 84    | 17.33 | 3411  | 1.26 |
| 30    | 40   | 1500  | 4P   | 96    | 14.99 | 2984  | 1.24 |
| 30    | 40   | 1500  | 4P   | 115   | 12.61 | 2491  | 1.46 |
| 30    | 40   | 1500  | 4P   | 125   | 11.56 | 2292  | 1.75 |